

KENT ELEGANT
RO + UF + TDS Control + UV Disinfection in Tank
COMPACT DESIGN

KENT
Mineral RO™
Water Purifiers
HOUSE of PURITY



HOUSE of PURITY



SERVICE

To request for service 24x7, download KENT Service App by scanning the QR code or by giving a missed call: 9212252852

To speak to customer care executive call: 92-789-12345

*T&C Apply

Instructions Handbook



100% HEALTH

100% PURE WATER

RETAINS ESSENTIAL MINERALS

KENT TECHNOLOGY
Removes Dissolved Impurities
Retains Essential Minerals
Multiple Purification
RO + UF + TDS Control + UV in Tank

Kent Deta Hai
Sabse Shudh Paani



Marketed by:
KENT RO SYSTEMS LTD.
E-6, 7 & 8, Sector-59, Noida, U.P.-201 309, India.
E-mail: sales@kent.co.in | Website: www.kent.co.in

Manufactured by:
KENT RO SYSTEMS LTD.
1) Khasra No. 93, Village-Bantakhedi, Tehsil-Roorkee, District-Haridwar, Uttarakhand-247 668, India.
2) A-6, Sector-87, Noida-201 305, U.P., India.

For customer complaints, contact our Customer Care Officer at:
E-6, 7 & 8, Sector-59, Noida, U.P.-201 309, India. Call: 92-789-12345
E-mail: service@kent.co.in or visit us at www.kent.co.in



Reverse Osmosis Water Purifier with UV Sterilization & TDS Controller.
The process & purifier is patented vide patent no. 199716.

Welcome to KENT

Dear Customer,

At the outset, allow us to thank you for your trust in **KENT** Water Purifier. We take pride in our reputation for product quality and industry proven performance. We are certain that your decision to own **KENT ELEGANT** Mineral RO™ Water Purifier will go a long way towards keeping you and your family in good health. We are confident that you will be satisfied with its performance and that it will serve your need for safer and cleaner drinking water without any compromise.

This guide will help you in getting the best out of your water purifier. Please go through this booklet to familiarise yourself with its operation and maintenance. You can look forward to years of trouble free service. To ensure that the warranty of your water purifier is effective, it is important that you fill up the enclosed warranty card and mail us the installation report within 15 days of purchase. In case you need any further information, contact your nearest KENT dealer or branch.

Best Wishes,

KENT RO SYSTEMS LTD.

Table of Contents

1. KENT TECHNOLOGY - A Breakthrough in Water Purification	1
2. Salient Features	1
3. Items in the Box	1
4. Important Instructions	2
5. Reverse Osmosis Process	3
6. UV Process	3
7. Water Flow Diagram	4
8. Electrical Circuit Diagram	4
9. UV LED Failure Alarm	5
10. Installation Instructions	5
11. TDS Adjustment	6
12. Starting-up the Purifier	6
13. Recommended Usage of Rejected Water	7
14. Maintenance	7
15. Important Safety Instructions	7
16. Technical Specifications	8
17. Testing Information	8

KENT TECHNOLOGY - A Breakthrough in Water Purification*

Presenting **KENT ELEGANT** Mineral RO™ Water Purifier, it uses futuristic and state-of-the-art technology to provide purer and healthier drinking water.

At the heart of **KENT ELEGANT** Mineral RO™ Water Purifier is a Reverse Osmosis membrane with capillaries as small as 0.0001 microns that reduce even dissolved impurities (salts and heavy metals) and even converts hard water to sweet and purer drinking water. The **KENT ELEGANT** Mineral RO™ Water Purifier also allows the user to control the Total Dissolved Solids (TDS) level of purified water.

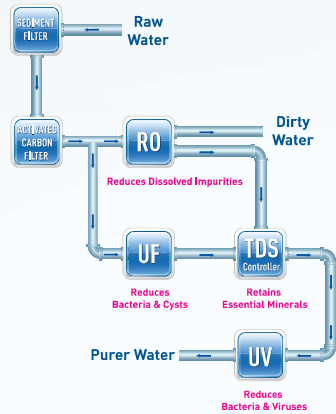







Salient Features of KENT ELEGANT Mineral RO™ Water Purifier

- Water purifier with UV disinfection in tank for absolute purification
- Wall-mountable KENT Technology water purifier
- Purification by RO + UF + TDS Control + UV in tank makes water pure
- Inbuilt TDS Controller that allows adjustment of TDS level of purified water
- Suitable for purification of brackish/tap water/municipal corporation water supply
- Fully automatic operation, with auto-on/off function
- RO Membrane fused inside membrane housing to prevent tampering
- Vertically mounted SMPS for protection from water
- Use of push-fit fittings for leakage and maintenance free performance
- Compact design, takes less space for installation
- ABS construction for corrosion free use
- 8L storage Tank

Items in the Box

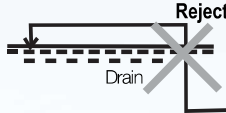
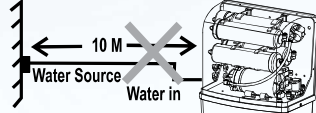
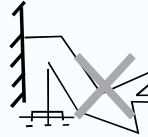
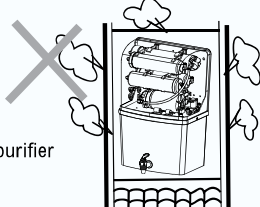
- | | |
|--|--------------|
| 1. KENT Elegant Mineral RO™ Water Purifier | : 1 No. |
| 2. 3-Way Connector | : 1 No. |
| 3. S.S. Ball Valve | : 1 No. |
| 4. Food Grade Pipe 1/4 inch (Blue) | : 2.5 m |
| 5. Food Grade Pipe 3/8 inch (White) | : 2.5 m |
| 6. Screws & Plastic Insert | : 2 No. each |
| 7. Sticker Center Drill | : 1 No. |
| 8. Warrnty Card | : 1 No. |

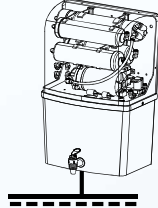
Important Instructions

 <p>Avoid exposure to direct sunlight and installation in damp areas.</p>	 <p>Make sure that the temperature of the water entering the purifier is within 10°C-40°C.</p>
 <p>Reject Water Drain</p> <p>Make sure that the reject water pipe is not placed at a level higher than the system, otherwise rejected water may flow backwards into the purifier.</p>	 <p>Maximum distance between the water source and the purifier should not be more than 3 meters.</p>
 <p>Avoid sharp bends in the pipe fittings. Do not bend or block the reject water pipe.</p>	 <p>Do not confine the purifier in a cabinet.</p>
 <p>In case of not using the purifier for more than two days, kindly switch off the power supply and drain the storage tank.</p>	 <p>To keep the storage tank clean, it should be drained once in 15 days.</p>
<p style="text-align: center;">KENT GENUINE SPARE PARTS</p> <p>Use Genuine KENT Spares for optimum performance.</p>	 <p>Do not try to service the purifier on your own. Instead, call a technician for help.</p>

Reverse Osmosis Process

The Reverse Osmosis process, also known as hyper filtration, is the finest filtration process known till date. The process ensures the reduction of particles as small as ions from a solution. Reverse Osmosis uses a semi-permeable membrane to reduce salts from potable / brackish water. In Reverse Osmosis, water pressure applied to the concentrated side forces the process of osmosis into reverse. Under enough pressure, treated water is "squeezed" through the membrane from the concentrated side to the diluted side. Salts dissolved in water as charged ions are repelled by the RO membrane. The rejected impurities on the concentrated side of the membrane are washed away in a stream of waste water, and thus do not get accumulated as in a traditional filter.

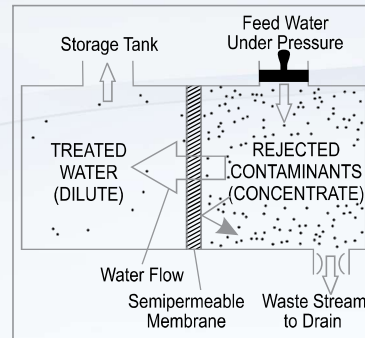

UV Process

The UV light has shorter wavelength (higher energy) than the visible light. It is called ultra-violet because it is just beyond the violet light in the light spectrum. Technically, the ultra-violet light is defined to be any wavelength of light, which is shorter than 400 nanometer.

UV rays, which penetrate into the micro-organisms, are absorbed by the DNA of the pathogen in the water. The DNA is altered in such a way that the pathogen cannot reproduce itself. Thus, they are essentially killed and cannot cause infection. This process of DNA modification is called inactivation.

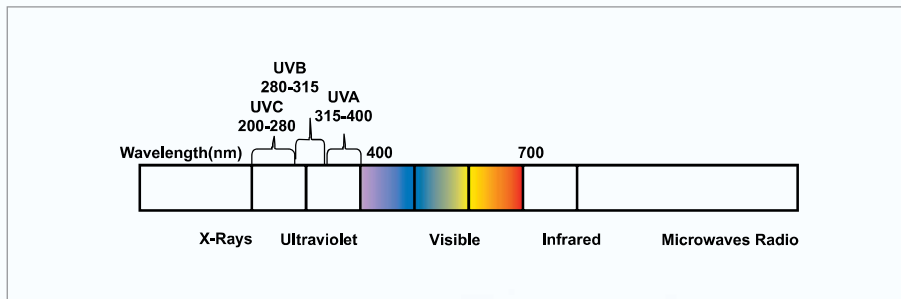

Note: The purified water stored in the tank is disinfected using UV LED, which automatically switches on for 30 minutes in a two hour cycle.

Water Flow Diagram

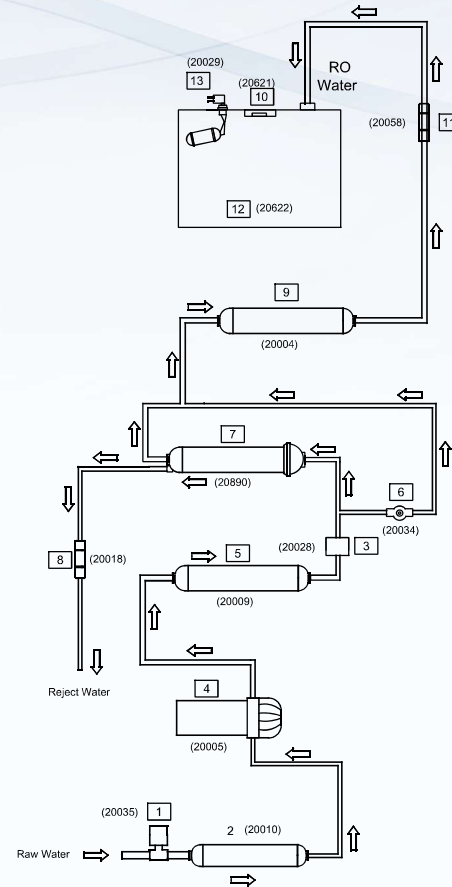

S.NO.	SPARE PART CODE	ITEM DESCRIPTION
1	20035	LOW PRESSURE SWITCH
2	20010	SEDIMENT FILTER
3	20028	SOLENOID VALVE
4	20005	BOOSTER PUMP
5	20009	ACTIVATED CARBON FILTER
6	20034	TDS CONTROL VALVE
7	20890	RO MEMBRANE
8	20018	FLOW RESTRICTOR TUBE
9	20004	UF MEMBRANE
10	20621	UV LED
11	20058	NON RETURN VALVE
12	20622	WATER STORAGE TANK
13	20029	FLOAT MICRO SWITCH

Electrical Circuit Diagram

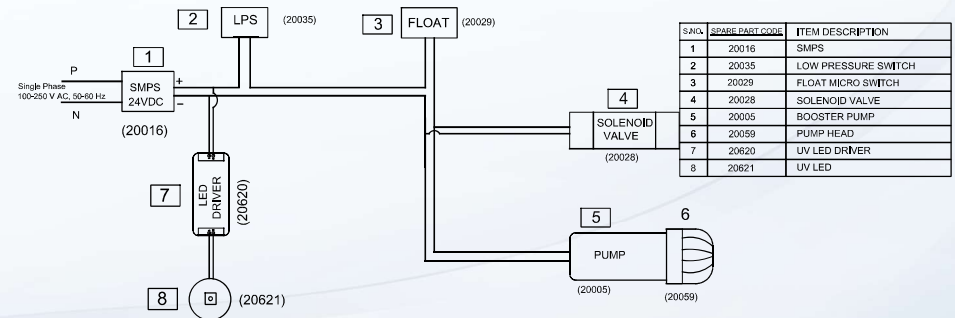

S.NO.	SPARE PART CODE	ITEM DESCRIPTION
1	20016	SMPS
2	20035	LOW PRESSURE SWITCH
3	20029	FLOAT MICRO SWITCH
4	20028	SOLENOID VALVE
5	20005	BOOSTER PUMP
6	20059	PUMP HEAD
7	20620	UV LED DRIVER
8	20621	UV LED

UV LED Failure Alarm*

KENT ELEGANT Mineral RO™ Water Purifier has in-built feature that sounds an audible alarm if the UV LED failure. This alarm will sound as follows:

2 short beeps after every 3 seconds for 3 minuts. The alarm will repeat after every 2.5 hours.

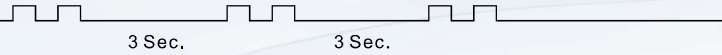

In case such an alarm is audible, call KENT service for LED replacement.

Installation Instructions

KENT ELEGANT Mineral RO™ Water Purifier is a product of advanced technology which ensures safe and clean drinking water. The purifier is easy and convenient to install.

Recommended Site Preparations:

- Single Phase 100-250V AC, 50-60 Hz. connection not more than 3m away from the point of installation of purifier
- Raw water supply with ½ inch nipple not more than 3m away
- Drain for rejected water not more than 3m away
- Space as per dimensions of the purifier
- Wall/plane surface for mounting two screws and holding the machine
- The system and installation must comply with state and local laws and regulations

Specific Instructions:

- KENT ELEGANT Mineral RO™ Water Purifier is a wall mountable purifier. Make sure that it is only mounted on a wall. Avoid installation on wooden and metallic stands
- For optimum performance and minimum inlet pressure required, ensure that the raw water supply tank is at least 10 ft above the level at which the purifier is installed
- It is preferable to install the purifier near a sink so that inlet and reject water lines are easily available

Installation Procedure:

Step-1

Wall Hanging Diagram

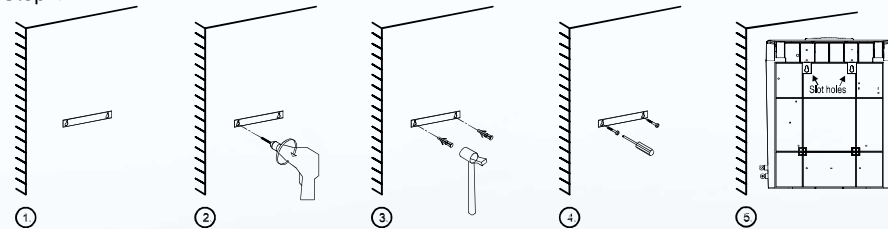

1. Paste the central drill sticker on wall at (3.6 Feet to 4.0 Feet from the ground) as per your convenience.
2. Ensure that sticker is pasted straight on the wall, then drill holes as per the space provided on sticker.
3. Now, insert the puff up with the help of a hammer.
4. Screw in two 10X50 self-taping screws, 5.4 inches (138 mm) apart horizontally.
5. Carefully hang the purifier on the wall with the help of wall-mounting slot holes provided on back side of the purifier.

Note:

1. If the wall is not straight or the screws are not properly drilled in an even position, it will damage your purifier.
2. Keep the device away from heat or direct sunlight.

Step-2

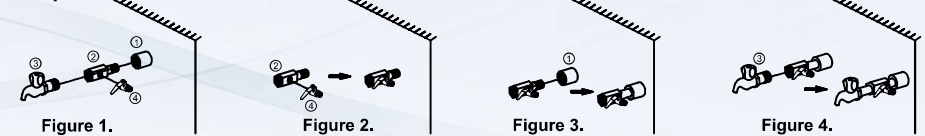

1. First fix the SS ball valve (marked as no. 4) to the inch port of the 3-way connector (marked as no. 2) as shown in figure 2.
2. Connect the 3-way connector to the raw water supply (marked as no. 1) as shown in the figure 3. The 3-way connector is fitted in line with the raw water supply.
3. The other end of the 3-way connector can be connected to a tap (marked as no.3) as shown in figure 4. or can be plugged off if not required.

Step-3

1. Now connect one end of the white pipe to SS ball valve and another end to the upper push-fit elbow fitting to the left hand side of the purifier labelled as WATER IN, as shown in fig 1.
2. Similarly, connect one end of the white pipe to the lower elbow fitting connector in tank labelled as REJECT WATER and leave the other end in the drain, as shown in fig 2.

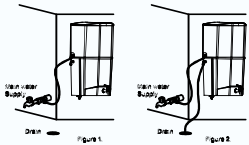

Step-4

Before connecting the power supply, it is important that you perform the following functions:

1. Open the SS ball valve (Handle parallel to the ball valve) to start the flow of water into the purifier, as shown in the figure.
2. Wait for 2-3 minutes to ensure that the filters are soaked in water.

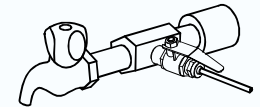

Step-5

1. Connect the power supply.
2. Installation is complete.

TDS Adjustment*

A unique feature in KENT ELEGANT Mineral RO™ Water Purifier is the TDS control valve, which is not available in any other domestic water purifier till date. This feature allows the user to control the content of natural minerals (TDS) in purified water.

To increase the TDS level, the user can turn

the screw of the valve anticlockwise; it will result in more mineral content in treated water. To reduce the TDS level, user can turn the screw valve clockwise, it will result in less mineral content in treated water. We recommend the TDS of the purifier to be kept at lowest but not below 50 mg/l.

Starting-up the Purifier

- Switch on the power supply
- Wait till the storage tank fully fills up**
- Switch off the power supply
- Drain the storage tank by opening the drain plug present at the bottom of the storage tank so as to remove any dust particles present in the pipes and storage tank
- Close the drain plug & switch on the power supply
- The purifier is ready to use

* Tested & certified by TUV-SUD South Asia (P) Ltd.

** Tested or certified flushing time - 24hrs.

Recommended Usage of Rejected Water

Although the rejected water has high concentration of salts, it is absolutely clean and free of impurities like chlorine, dirt, sand, etc. which are present in raw water. This rejected water usually goes down the drain but if required, can be used for gardening purposes. It has high concentration of salts and minerals which accelerates plant growth. Rejected water can also be used for cleaning purposes, i.e. cleaning utensils, mopping, etc.

Maintenance

To ensure that the purifier operates at its BEST, routine maintenance must be performed. Frequency of the maintenance will greatly depend upon the raw water quality and consumption of purified water.

- The storage tank must be drained once in 2 weeks. Open the drain plug present at the bottom of the storage tank and drain the tank completely. Plug back the drain plug and switch on the power supply
- Replace the sediment filter & activated carbon filter once in 12 months. It is recommended to change the FRT along with the filters
- Replace the RO membrane once in a year
- Replace the UF membrane once in a year
- In the event of not using purifier for a long time (while going for a holiday, tour etc.), make sure that you disconnect the power supply, turn off the raw water supply and drain the storage tank

Note: The Reverse Osmosis system contains a replaceable treatment component critical for the effective reduction of total dissolved solids and that product water shall be tested periodically to verify that the system is performing properly.

Replacement of spare parts are as under:

-20010	SP	Inline Sediment Filter 8"
-20009	SP	Inline Carbon Filter 8"
-20890	SP	RO membrane Welded 7" Housing
-20004	SP	UF Membrane 8" Housing
-20018	SP	FRT 550/600

Note: Filters and membrane are consumables. Their replacement time is dependent on the quality of raw water and water consumption. They are not covered under the warranty. However, if a filter chokes within six months and a membrane within a year, it will be cleaned/ repaired/ replaced free of cost. Changing the filters and system inspection is available on call. The treatment capacity of RO membrane will reduce with time due to clogging of pores of membranes.

"This Reverse Osmosis System contains a replaceable component critical to the efficiency of the system. Replacement of the reverse osmosis component should be with identical specifications as defined by the manufacturer, to ensure the same efficiency and contaminant reduction performance."

Note: In case of UV LED failure the machine sounds an alarm with two beeps. Contact KENT Service to replace the UV LED

Important Safety Instructions

- If the supply cord is damaged, it must be replaced by the original part in order to avoid hazard
- Children should be supervised to ensure that they do not play with the appliance
- This appliance is not intended for use by persons (including children) with reduced physical, sensory or mental capabilities, or lack of experience and knowledge, unless they have been given supervision or instruction concerning use of the appliance by a person responsible for their safety

Technical Specifications

Product	KENT ELEGANT
Product Code	11097
Product Generic Name	Water Purifier
Colour	White
Applications	Suitable for Purification of Brackish/Tap Water/ Municipal Corporation Water
Purification Production Rate	15 L/hr.*
Body Material	ABS Food Grade Plastic
Mounting	Wall-mounting
Dimensions (mm)	340 (L) x 265 (W) x 505 (H)
Inlet Water Pressure/Temp (Min.)	0.3 kg/cm ² /10°C
Inlet Water Pressure/Temp (Max.)	4 kg/cm ² /40°C
Min./Max. Operating pH	6.5-8.0
Filter Cartridge	Sediment, Activated Carbon, UF
UV LED Wattage	0.7W
Net Weight	6.62 kg
Storage Capacity	8L
Maximum Duty Cycle	75 L/day
Membrane Type	Thin Film Composite RO
UF Membrane	0.1-0.01 Microns
Booster Pump Voltage	24V DC
Total Power Consumption	60 W
Input Power Supply	Single Phase 100-250V AC, 50-60 Hz. 
IP Rating	IPX1

* Purification capacity tested for raw water having TDS level of 750 ppm at room temperature.

Testing Information

The System has been tested according to IS 10500:2012 (Standards for drinking water as per Bureau of Indian Standards) for reduction of the hazardous substances.